

REVISIONS		
REV	DESCRIPTION	APP'D/ DATE
A	3006-AC-0017 (A) WAS (-); 3006-AC-0016 (B) WAS (A)	03/05/07 JJR
B	0018-2A-0006 (C) WAS (A)	2/4/14 JJR
C	REMOVED "REV." COLUMN FROM ITEM LIST.	2/24/14 CIW
D	ITEM 9, 0030-0030 BIND. HD. M.S. 1/4" LG. WAS 0030-0029 1/2" LG.	7/23/14 CIW

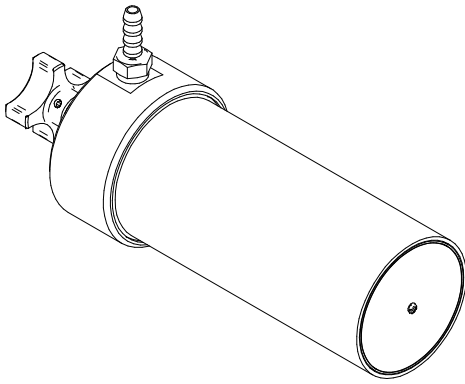
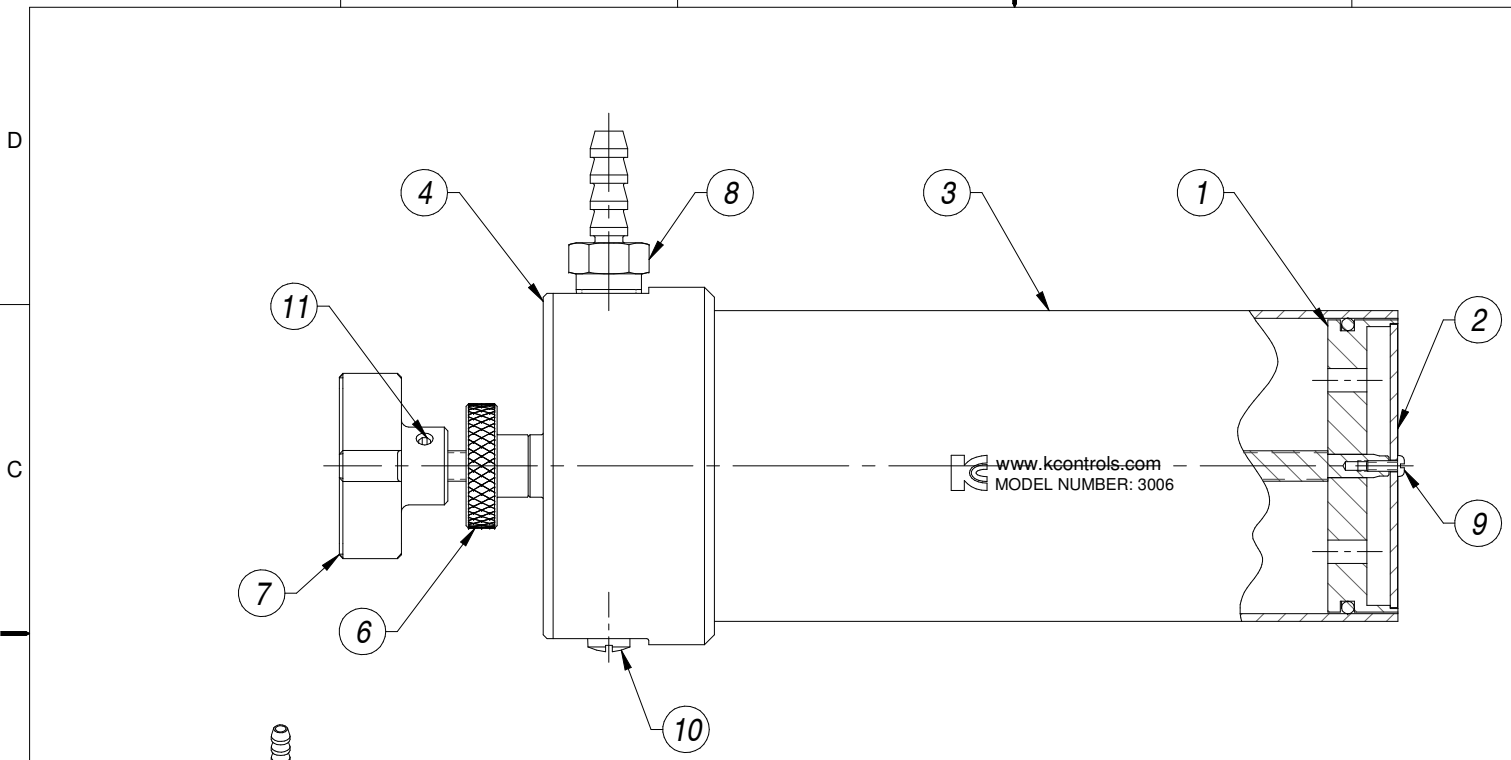

ITEM	PART NUMBER	DESCRIPTION	QTY	UOM
11	0035-2A-0004	SET SCREW, S.S., 8-32 X 3/16" LONG	1	EA
10	0030-2A-0005	BINDING HEAD M.S., S.S., 8-32 X 1/4" LONG	1	EA
9	0030-2A-0030	PAN HEAD M.S., 2-56 X 1/4" L. (S.S.)	1	EA
8	2007-2A-0015	MALE HOSE BARB, S.S., 1/4" N.P.T. X 1/4" I.D.	1	EA
7	0018-2A-0006	KNOB, ALUMINUM, 1-1/2" Ø WITH 1/4-20UNC TAP	1	EA
6	0018-2A-0004	THUMBNUIT, KNURLED, 1/4-20UNC, 1.00" O.D.	1	EA
5	0016-2A-5060	O-RING, SILICONE, -138 SIZE	1	EA
4	3006-AC-0017	CAP, FOR 2.50" FILLING GUN	1	EA
3	3006-AC-0016	BARREL, 2.50" O.D. X 2.38" I.D. X 6.00" LONG	1	EA
2	3006-AC-1020-20	FILTER, 316 S.S., 20 MICRON	1	EA
1	3006-AC-1018	PISTON/ STEM ASSEMBLY	1	EA

LIST OF MATERIALS

THIS DRAWING, INCLUDING ALL INFORMATION CONTAINED HEREON, IS THE EXCLUSIVE PROPRIETARY PROPERTY OF KINEMATICS AND CONTROLS CORPORATION. IT IS DISCLOSED WITH THE UNDERSTANDING IT WILL BE RETAINED IN CONFIDENCE, AND WILL NEITHER BE DUPLICATED NOR COPIED IN WHOLE OR IN PART, NOR USED FOR ANY PURPOSE OTHER THAN THAT FOR WHICH DISCLOSED. THIS DRAWING IS TO BE RETURNED UPON REQUEST.

FINAL ASSY	TOLERANCES: EXCEPT AS NOTED	APPROVALS:	DATE:	KINEMATICS & CONTROLS CORP. www.kcontrols.com
3006-AC-1015	FRACTIONS: ± 1/64 DECIMALS: .XX ± .01 XXX ± .005 ANGLES: ± 1/2°	DRAWN: J.RAK MECHANICAL ENGR	2/14/07	
NEXT ASSY	MATERIAL: -	ELECTRICAL ENGR:		TITLE: FILLING GUN ASSEMBLY Ø2-3/8" I.D. x Ø2-1/2" O.D.
3006-AC-1015	FINISH: -	MANUFACTURING:		DRAWING NO. 3006-SE-1015
DO NOT SCALE DRAWING				SCALE: NONE